

**THE IDEAL
SOLUTION
FOR UNWANTED
TEXTURE**



Smooth-It

For a fast, clean transformation
to flat walls and ceilings

ARTEX



Artex

Smooth-It can be applied to textured or damaged walls and ceilings to achieve a perfect smooth surface that is ready to decorate.

Smooth-It Powder



3 Easy Steps

- 1 | Open bag and mix to correct consistency
- 2 | Apply evenly using the smoothing out tool and spatula where necessary (re-apply where the texture pattern requires)
- 3 | Leave for 24–36 hours, depending on atmospheric conditions, to dry white and then paint if required

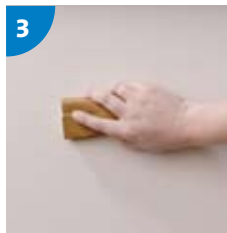

Smooth-It Ready-Mix



3 Easy Steps

- 1 | Open tub
- 2 | Apply evenly using the smoothing out tool and spatula where necessary (re-apply where the texture pattern requires)
- 3 | Leave for 24–36 hours, depending on atmospheric conditions, to dry white and then paint if required

Features

- Dries in 24–36 hours
- Can be applied directly to painted surfaces
- Dries white
- Available in Powder and Ready-Mix
- High coverage – over 4m² per ready-mix tub 20m² per 25kg bag (coverage is dependent upon texture/pattern)

Benefits

- Complete your project in no time
- No need to prepare the textured wall or ceiling – a real time saving
- For ease of decoration
- Giving greater choice for large and small jobs and any level of experience
- Represents great value-for-money when compared to alternative products



THISTLE
PLASTER PRODUCTS



GYPROC
PROFESSIONAL TOOLS

GYPROC
PLASTERBOARD PRODUCTS

SPEEDTAPE

SPEEDTAPE PRO

GYPFRAME
METAL PRODUCTS

ARTECO
CEILING PRODUCTS

ISOVER **Tetrion**

Artex, Thistle, Blue Hawk, Gyproc Speedtape, Speedtape Pro, Gypframe and Arteco are all registered trademarks of BPB United Kingdom Limited part of the Saint-Gobain Group.

Artex Limited reserve the right to revise any product specification without notice. The information given is correct to the best of our knowledge at the time of publication, but it is the user's responsibility to ensure it remains current prior to use.

The enclosed information should not be read in isolation as it is meant only as guidance for the user, who should always ensure that they are fully conversant with the products, systems and specification being used and their subsequent installation prior to the commencement of work or a job.

We advise that you read and familiarise yourself with all the information contained in this literature prior to the commencement of the work, job or specification. For a comprehensive and up to date library of information visit our website at: www.artexltd.com

Artex Ltd
Head Office
Pasture Lane
Ruddington
Nottingham
NG11 6AE

www.artexltd.com

© Artex May 2008 2274-SI-DL-01

FREEPHONE

0800 032 6345

The Artex logo is a registered trademark of BPB United Kingdom Limited part of the Saint-Gobain Group.

